

Kensington®

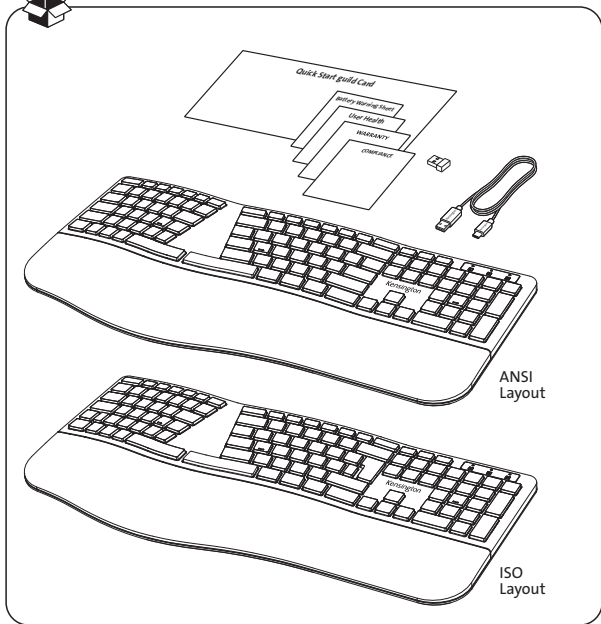

Pro Fit™ Ergo KB680 EQ Rechargeable Keyboard Clavier rechargeable Pro Fit™ Ergo KB680 EQ



kensington.com/register

1

Power on/off | marche / arrêt | marche / arrêt | Einschalten / Ausschalten |
Accensione/spengimento | Encendido / apagado | Ligar/desligar |
تشغيل/إيقاف التشغيل | 電源のオン/オフ | 電源开/关

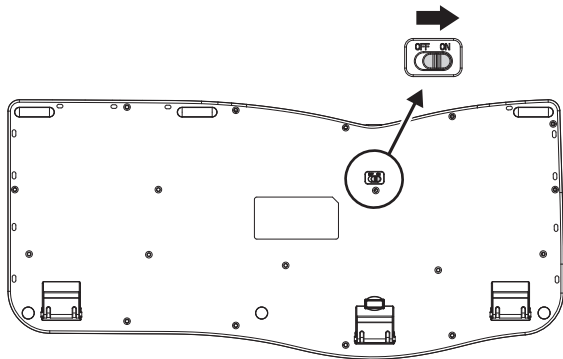
**2**

Pairing mode | Mode de couplage | Mode d'appairage | Kopplungsmodus |
Modalità di Abbinamento | Modo de emparejamiento |
Modo de emparelhamento | وضع الاقتران | ペアリングモード | 配对模式

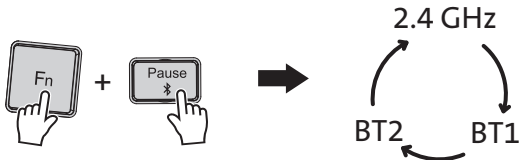

3

 2.4GHz

a

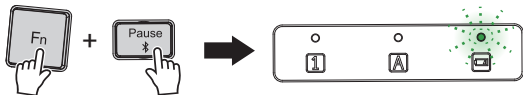

b

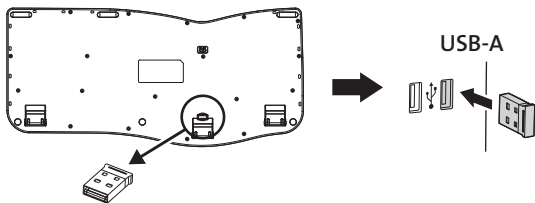

c

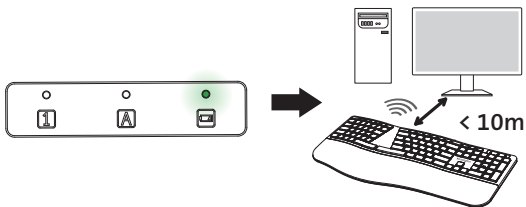

 Bluetooth®

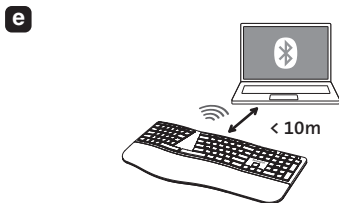
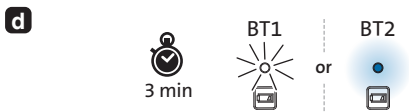
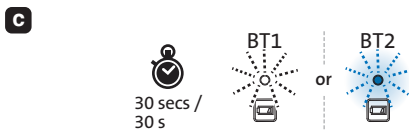
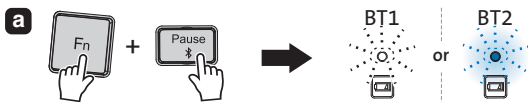

Num Lock |
 Verrouillage numérique |
 Verrouillage numérique |
 Num-Taste | Bloq. Núm. |
 Bloc Num (blocco numeri) |
 Num Lock | Num Lock |
 数字锁定键 | Num Lock

Charging | Charge en cours |
 En charge | Laden | Ricarica |
 Carga | Em carregamento |
 الشحن | 充电中 | 充電中

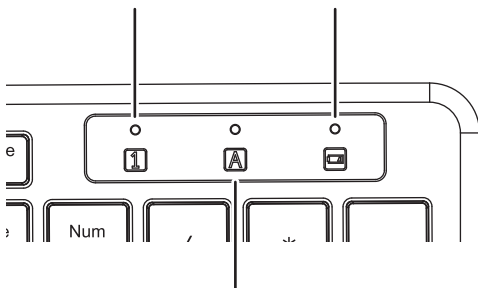

Caps Lock | Verrouillage majuscule |
 Verrouillage des majuscules |
 Feststelltaste | Bloq. Mayús. |
 Bloc Maiusc (blocco maiuscole) |
 Caps Lock | Caps Lock | 大写锁定键 |
 Caps Lock

5



a

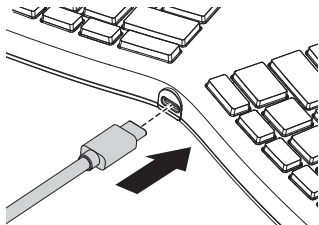

b

USB-A

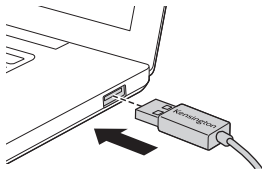

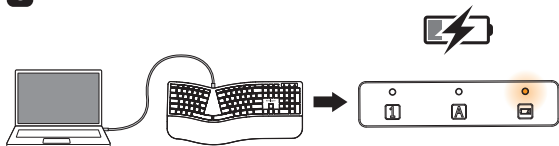
C

Requires a minimum of 5V/0.3A (1.5W) of USB power to properly charge the keyboard. | Le clavier nécessite une alimentation USB d'au moins 5 V/0,3 A (1,5 W) pour être correctement rechargé. | Nécessite une alimentation USB de minimum 5V/0.3A (1.5W) USB pour correctement charger le clavier. |

Zum ordnungsgemäßen Aufladen der Tastatur ist ein USB-Anschluss mit einer Ausgangsleistung von mindestens 5V/0.3A (1.5W) erforderlich. |

Per caricare correttamente la tastiera, è necessaria un'alimentazione USB di almeno 5V/0.3A (1.5W). | Requiere una alimentación USB de un mínimo de 5V/0.3A (1.5W) para cargar el teclado adecuadamente. |

Requer um mínimo de 5V/0.3A (1.5W) de potência USB para carregar corretamente o teclado. |

يتطلب ما لا يقل عن 5 فولت/0.3 أمبير (1.5 واط) من طاقة USB لشحن لوحة المفاتيح بشكل صحيح. |
 キーボードを正しく充電するには、5V/0.3A (1.5W) 以上の USB 電力が必要です。 |
 为键盘充电至少需要最低 5V/0.3A (1.5W) 的 USB 电源。



6

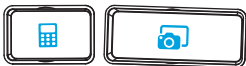







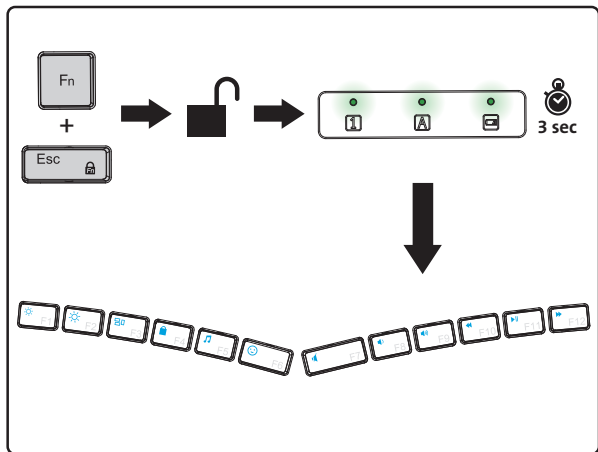

	Calculator Calculatrice Calculatrice Taschenrechner Calcolatrice Calculadora Calculadora الآلة الحاسبة 計算機 計算器
	Screen Shot Capture d'écran Capture d'écran Screenshot Screenshott Captura de pantalla Captura de ecrã لفظة شاشة スクリーンショット 載屏

Requires Kensington Connect | Nécessite Kensington Connect |
 Nécessite Kensington Connect | Erfordert Kensington Connect |
 Richiede Kensington Connect | Requiere Kensington Connect |
 Requer o Kensington Connect | Kensington Connect تتطلب |
 Kensington Connect が必要 | 需使用 Kensington Connect |

7



	Decrease Screen Brightness Réduire la luminosité de l'écran Baisse de la luminosité Helligkeit verringern Diminuire luminosità Bajar brillo Diminuir o brilho تقليل مستوى السطوع 明るさを下げる 调低亮度
	Increase Screen Brightness Augmenter la luminosité de l'écran Augmenter la luminosité Helligkeit erhöhen Aumenta luminosità Aumentar el brillo Aumentar Luminosidade زيادة السطوع 明るさを上げる 调高亮度
	Task view Vue des Tâches Taskanzeige Visualizzazione attività Vista de tareas Vista de tarefas عرض المهمة タスクビュー 任务视图
	Screen Lock Verrouillage de l'écran Verrouiller écran Bildschirmsperre Blocco schermo Bloqueo de pantalla Bloqueio de ecrã تأمين الشاشة スクリーンロック 屏幕锁定
	Media Player Lecteur multimédia Lecteur multimédia Medienplayer Lettore multimediale Reproductor multimedia Reprodutor de mídia مشغل الوسائط メディアプレーヤー 媒体播放器
	Emoji Keyboard Clavier Emoji Clavier émoticône Emoji-Tastatur Tastiera emoji Teclado emoji Teclado Emoji لوحة المفاتيح رموز تعبيرية 絵文字キーボード 表情符号键盘
	Mute Speaker Couper le son du haut-parleur Désactiver le haut-parleur Lautsprecher stummschalten Disattivazione dell'altoparlante Silenciar altavoz Silenciar altifalante كتم صوت السماعات スピーカーをミュートにする 扬声器静音
	Decrease Volume Diminuer le volume Réduire le volume Lautstärke verringern Diminuzione del volume Bajar volumen Diminuir volume خفض مستوى الصوت 音量を下げる 调低音量
	Increase Volume Augmenter le volume Augmenter le volume Lautstärke erhöhen Aumento del volume Subir volumen Aumentar volume رفع مستوى الصوت 音量を上げる 调高音量

	Back Retour Face arrière Rückseite Indietro Atrás Retroceder اللوحة الخلفية 戻る 后退
	Play/Pause Lecture/pause Lecture/Pause Abspielen/Pause Riproduci/Pausa Reproducir/Pausar Reproduzir/ Colocar em Pausa تشغيل/إيقاف مؤقت 再生/一時停止 播放/暂停
	Forward Avance Commande d'avance Vorwärts Avanti Adelante Avançar التالي 進む 前进

8

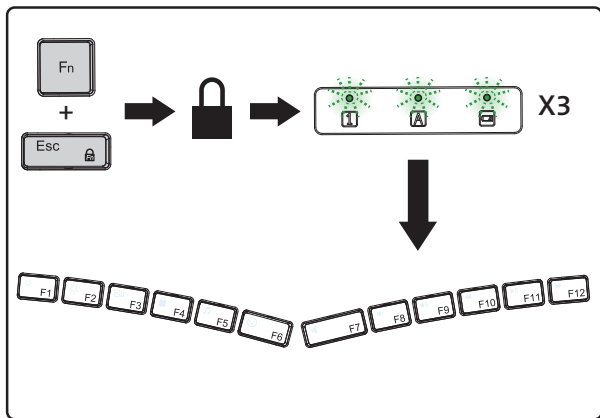

9



Microsoft Copilot



EN Download Kensington Konnect™ today: www.Kensington.com/software/hub

FR-CA Téléchargez Kensington Konnect™ aujourd'hui :
www.Kensington.com/software/hub

DE Kensington Konnect™ noch heute herunterladen:
www.Kensington.com/software/hub

FR Téléchargez Kensington Konnect™ dès aujourd'hui :
www.Kensington.com/software/hub

IT Scarica subito Kensington Konnect™: www.Kensington.com/software/hub

ES Descargue ya Kensington Konnect™: www.Kensington.com/software/hub

PT Descarregue hoje o Kensington Konnect™: www.Kensington.com/software/hub

AE باءر بئنزىل برنامء Kensington Konnect™ الءىوم: www.Kensington.com/software/hub

CN 立即下载 Kensington Konnect™: www.Kensington.com/software/hub

JP 今すぐKensington Konnect™ をダウンロードしてください:
www.Kensington.com/software/hub





www.kensington.com/support

Kensington® and Pro Fit™ are trademarks of ACCO Brands. All other registered and unregistered trademarks are the property of their respective owners.

© 2025 Kensington Computer Products Group, a division of ACCO Brands.

Patents: <https://www.accobrand.com/patents/>

Kensington® et Pro Fit™ sont des marques commerciales d'ACCO Brands. Toutes les autres marques déposées et non déposées sont la propriété de leurs propriétaires respectifs.

© 2025 Kensington Computer Products Group, une division d'ACCO Brands.

Brevets : <https://www.accobrand.com/patents/>

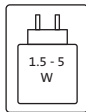

K75412/K72485