

1 ATTACH CURVED UPRIGHT ASSEMBLY TO BASE

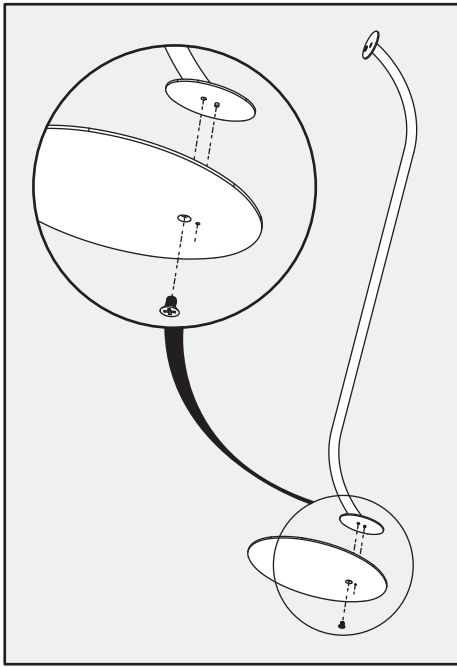

1
Align post in bottom of **curved upright assembly** with small hole in **base**. Insert 5/16" x 1/2" screw through large hole in base and into nut in **curved upright assembly**. Tighten firmly.

2 ATTACH SIGN HOLDER PLATE TO UPRIGHT ASSEMBLY

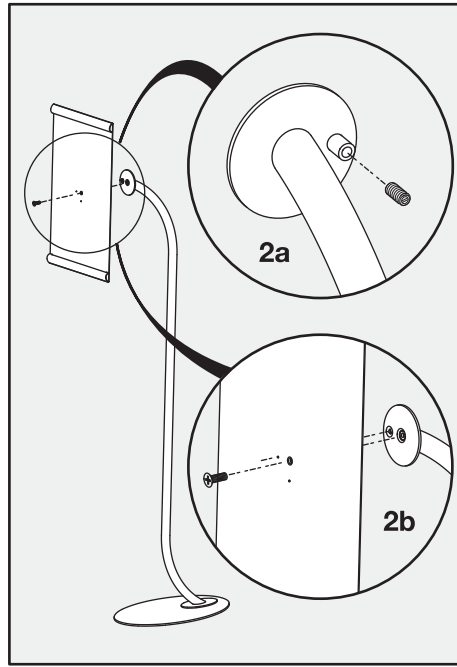

2
(a) Insert **spring plunger** into nut in back of **curved upright assembly plate**. Tighten until round "nose" of spring plunger extends through front of plate.
(b) With **sign holder plate** in vertical position and **spring plunger** aligned with small offset hole, insert #8 x 1/2" screw through center hole of sign holder plate and into nut in center of **curved upright assembly plate**. Tighten firmly.

3 ADJUST SIGN HOLDER PLATE

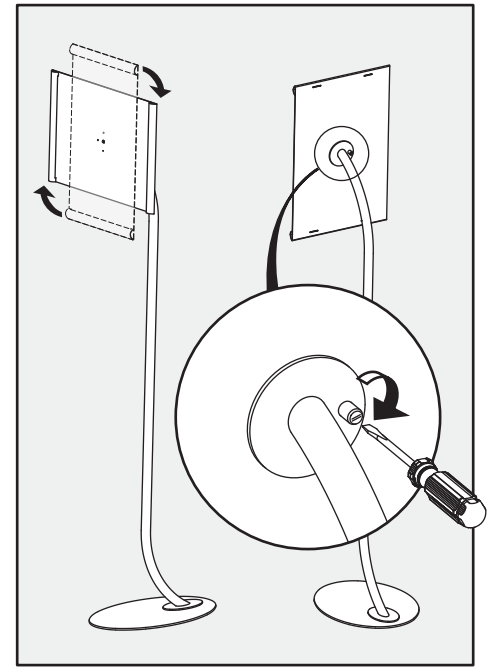

3
For horizontal signs, rotate **sign holder plate** until round tip of spring plunger "clicks" into other hole in plate. Note: pressure needed to rotate **sign holder plate** can be adjusted by loosening or tightening **spring plunger**.

4 INSERT SIGN HOLDER WITH SIGN INTO SIGN HOLDER PLATE

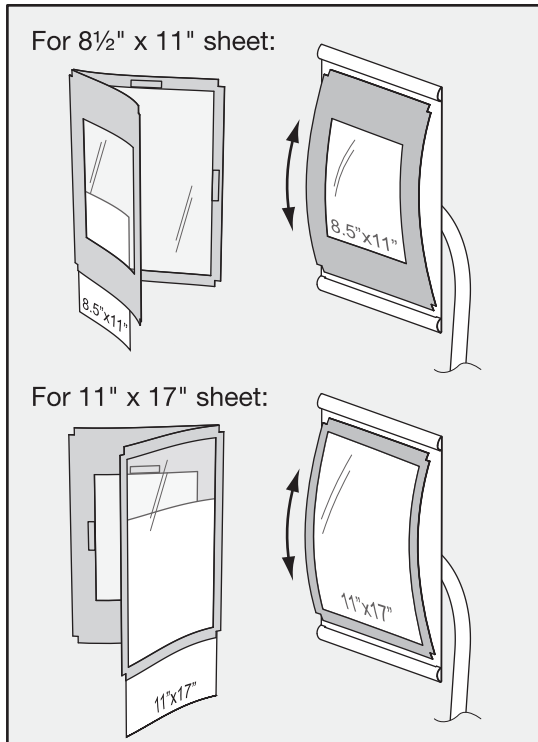

4
To display signs, secure 8-1/2" x 11" or 11" x 17" sign under plastic tabs on corresponding side of **sign holder**. Insert bottom tab of **sign holder** into cutout at bottom of **sign holder plate**. Flex **sign holder** and insert top tab of sign holder into cutout at top of **sign holder plate**.

Tools Required

Phillips Screw Driver Slotted Screw Driver



Designer Sign Stand Assembly Instructions (No. 7922)

Parts

